

Digital CROS/BiCROS

LIAISON™

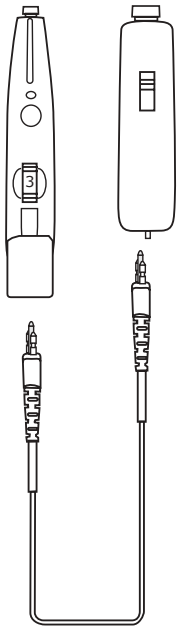

CROS mode:

Attach audio input battery door unit to Liaison™ aid (see instructions below). Connect cord to battery door unit and to offside microphone unit. Program Liaison in Unifit™ by selecting Direct Audio Input environment and DAI input option on the Quick Fit screen.

BiCROS mode:

Attach audio input battery door unit to Liaison aid (see instructions below). Connect cord to battery door unit and to offside microphone unit. Program Liaison in Unifit by selecting Direct Audio Input environment and Mic + DAI input option on the Quick Fit screen.

Note:

- CROS or BiCROS will **not** function in any program using Omni, D-Adaptive or D-Fixed as the input because telecoil input is required.

CONVERSA™ AND UNISON™

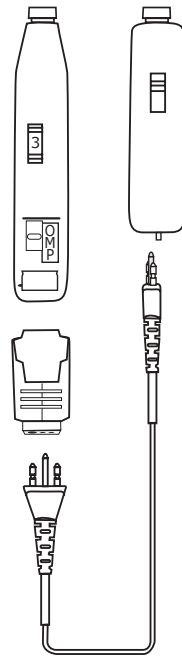

CROS mode:

Ensure sticker has been removed from audio input contacts on the Conversa™ or Unison™ aid. (See shoe instructions). Connect Conversa and Unison series CROS shoe (*identified by MO5A marking and black rectangle*) to hearing aid. Connect cord to shoe and to microphone unit.

BiCROS mode:

Ensure sticker has been removed from audio input contacts on Conversa or Unison aid. (See shoe instructions). Connect Conversa and Unison series BiCROS shoe (*identified by AS5A marking and blue rectangle*) to hearing aid. Connect cord to shoe and to microphone unit.

Note:

- The CROS/BiCROS option is available with Unison and Conversa **only** when the hearing aid is set to the **omnidirectional** mode.
- All models operate normally when CROS/BiCROS cords and/or shoes are removed.

To equip Liaison BTEs for CROS or BiCROS applications:

Replace the standard battery door with optional direct audio input battery door unit.

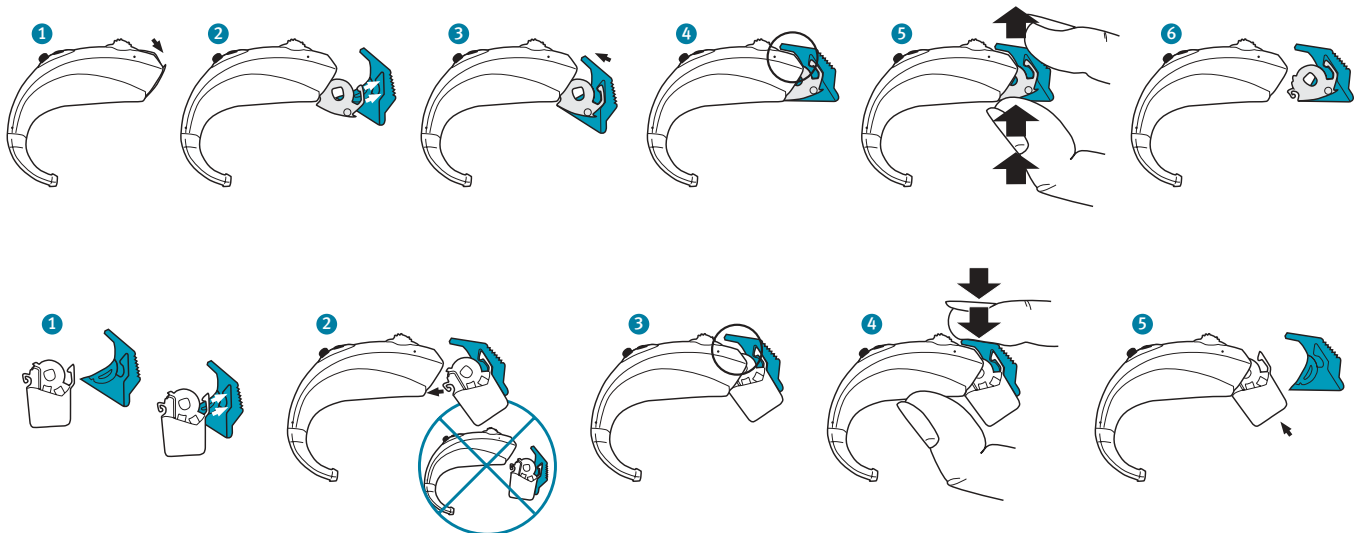

Digital CROS/BiCROS

MICROPHONE UNIT, CORDS AND SHOES FOR ALL DIGITAL SERIES

Model	Microphone Unit	Shoes	Cords
Liaison CROS	<ul style="list-style-type: none"> • 1 microphone unit required • Unitron Hearing mini mic unit • Available in beige • No battery required in microphone unit 	<ul style="list-style-type: none"> • 1 Liaison BTE with optional direct audio input battery door unit required • Available in clear 	<ul style="list-style-type: none"> • 1 CROS/BiCROS type B cord required • Choice of lengths (<i>see below</i>)
Liaison BiCROS	<ul style="list-style-type: none"> • 1 microphone unit required • Unitron Hearing mini mic unit • Available in beige • No battery required in microphone unit 	<ul style="list-style-type: none"> • 1 Liaison BTE with optional direct audio input battery door unit required • Available in clear 	<ul style="list-style-type: none"> • 1 CROS/BiCROS type B cord required • Choice of lengths (<i>see below</i>)
Conversa and Unison CROS	<ul style="list-style-type: none"> • 1 microphone unit required • Unitron Hearing mini mic unit • Available in beige • No battery required in microphone unit 	<ul style="list-style-type: none"> • 1 Conversa/Unison CROS shoe (<i>identified by black rectangle</i>) required • Available in clear 	<ul style="list-style-type: none"> • 1 CROS/BiCROS type B cord required • Choice of lengths (<i>see below</i>)
Conversa and Unison BiCROS	<ul style="list-style-type: none"> • 1 microphone unit required • Unitron Hearing mini mic unit • Available in beige • No battery required in microphone unit 	<ul style="list-style-type: none"> • 1 Conversa/Unison BiCROS shoe (<i>identified by blue rectangle</i>) required • Available in clear 	<ul style="list-style-type: none"> • 1 CROS/BiCROS type B cord required • Choice of lengths (<i>see below</i>)

CORD LENGTHS:

Type B 20 cm/7.87" 22.5 cm/8.59" 25 cm/9.84" 27.5 cm/10.83"



NOTE: Cord length measurement should be made from ear to ear, behind the head.

CORPORATE OFFICE
Kitchener, Ontario, Canada
877 492 6244; 519 895 0100

CANADA
Cambridge, Ontario
800 265 8255; 519 650 9111

EUROPE
Bremen, Germany
49 421 43 87 90

INTERNATIONAL
Kitchener, Ontario, Canada
519 895 0100

NETHERLANDS
Nieuwegein, The Netherlands
+31 (0) 30 604 9325

UK
Warrington, Cheshire, England
01925 247810

U . S . A .
Plymouth, Minnesota
800 888 8882; 763 744 3300



www.unitronhearing.com