

Direct Audio Input



LIAISON™

AUDIO INPUT UNIT FEATURES

- Replace Liaison™ battery door with optional direct audio input battery door unit (see instructions on reverse)
- Integrated contacts for superior reliability and reduced interference
- Can be left attached to the hearing aid indefinitely
- Audio input is programmed with the Direct Audio Input environment in Unifit™
- Compatible with Phonak MLx system
- Suitable for use with Phonic Ear, Phonak, Telex and other FM systems, lapel microphones and many other audio applications
- Receptacle: 3 pin polarized plug (Europlug)

PROGRAMMING LIAISON™ FOR DIRECT AUDIO INPUT USE

- To program a Liaison hearing aid for use with audio input, select the Direct Audio Input environment for the desired program(s) in Unifit
- To achieve audio signal only (hearing aid microphone off), choose DAI for the input option in the DAI program
- For audio plus hearing aid (hearing aid microphone on), select Mic+DAI as the input option

NOTE: DAI will **not** function in programs using Omni, D-Adaptive or D-Fixed as the input because DAI functions through the telecoil input

CONVERSA™/UNISON™ – SHOE FEATURES

- Compatible with Unitron Hearing direct audio input hearing aids
- Unison™ and Conversa™ use separate shoes for hearing aid microphone on versus microphone off applications
- Compatible with Phonak MLx system
- Suitable for use with Phonic Ear, Phonak, Telex and other FM systems, lapel microphones and many other audio applications
- Receptacle: 3 pin polarized plug (Europlug)

ALL OTHER MODEL – SHOE FEATURES

- Compatible with Unitron Hearing direct audio input hearing aids (Icon/Sound F/X, US, UM, UE, series)
- Conveniently located two-position microphone switch



M = hearing aid microphone on (audio input signal and hearing aid microphone function simultaneously)

Ⓜ = hearing aid microphone off (audio input signal only)

- Compatible with Phonak MLx system (except UE or UM series)
- Suitable for use with Phonic Ear, Phonak, Telex and other FM systems, lapel microphones and many other audio applications
- Receptacle: 3 pin polarized plug (Europlug)

Direct Audio Input

SHOE COLOR

UE Series	beige, brown
UM Series	beige, brown, gray
US Series	beige, brown, gray, taupe
ICON	clear
Sound F/X	clear
Unison	clear
Conversa	clear
Liaison	clear/beige

AUDIO CORDS

All our audio cords have a 3-pin polarized plug that fits into the unit.

The Unित्रon Hearing shoes and audio input units also accept 3-pin polarized Phonic Ear, Phonak and Telex cords.

Cords for General Applications

Cords: co-axial (shielded).

Standard connecting plug: 3.5 mm (1/8").

	Monaural	Binaural
Style	straight	Y-cord
Length	93 cm (37")	80 cm (32")

For use with Walkmans, Phonic Ear Easy Listener, and other general applications.

Cords for Auditory Training and FM Systems

Standard connecting plugs to FM systems*:

- Right-angle, 2-pin non-polarized plug (Phonic Ear 475 & Telex)
Overall Length: 60 cm (24")
- Right-angle, 3-pin non-polarized plug (Phonak Microvox or Phonic Ear Solaris)
Overall Length: 60 cm (24") or 75 cm (30")

Cord: co-axial (shielded)

Styles: straight (monaural) or Y-cord (binaural)

Note: When setting our audio unit or shoe with FM systems:

- 1) Set hearing aid volume control to the wearer's typical setting
- 2) Gradually increase FM system volume to the wearer's comfortable listening level. A typical setting could be very low (1 1/2 - 2)

*Shoe cords may not connect to all FM models.

TO EQUIP LIAISON™ BTEs FOR DIRECT AUDIO INPUT APPLICATIONS:

Replace the standard battery door with optional direct audio input battery door unit.

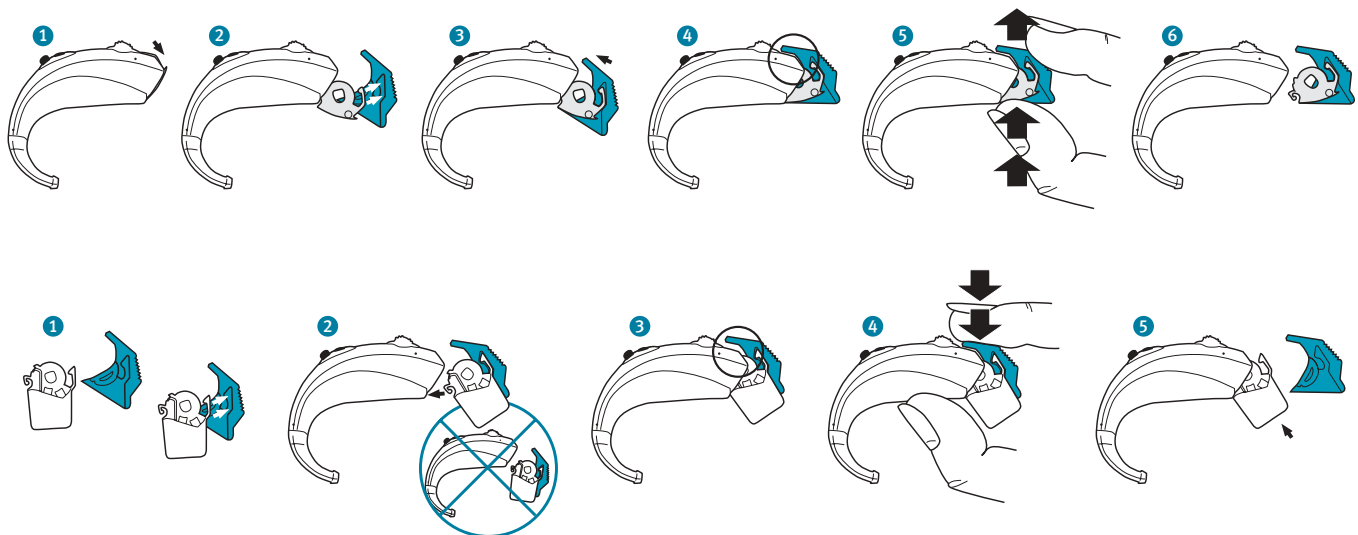

CORPORATE OFFICE
Kitchener, Ontario, Canada
877 492 6244; 519 895 0100

CANADA
Cambridge, Ontario
800 265 8255; 519 650 9111

EUROPE
Bremen, Germany
49 421 43 87 90

INTERNATIONAL
Kitchener, Ontario, Canada
519 895 0100

NETHERLANDS
Nieuwegein, The Netherlands
+31 (0) 30 604 9325

UK
Warrington, Cheshire, England
01925 247810

U.S.A.
Plymouth, Minnesota
800 888 8882; 763 744 3300



www.unitronhearing.com